

## **Prefabricated House**



As a professional, innovative international manufacturer, our supplier is a leading company specialized in Designing, Marketing and Construction of the prefabricated houses. They have been certificated by ISO 9001:2000 and ISO 14001:2004 which is again confirmed this company as a very good. They have earned confidence from all clients who are concentrated on the road & bridge, railway, construction and hydraulic industries, because of their professional service from designing to installation.

This supplier can designs and manufactures several types of prefabricated houses. These prefabricated houses are mainly classified against different usage and different climate condition, and their size and layout can be adjusted.

**Can be divided into three basic groups:**

- **CONTANER HOUSES**
- **HOUSES**
- **WAREHOUSES**

# Container House

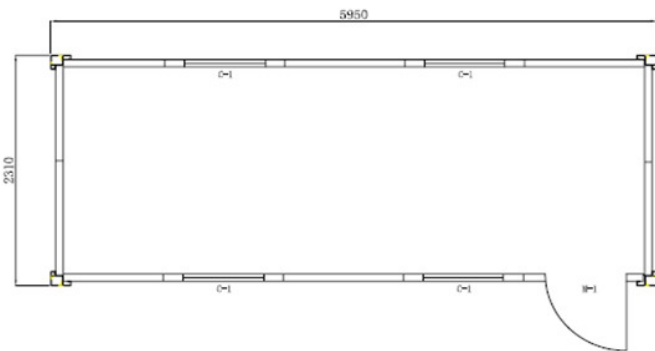
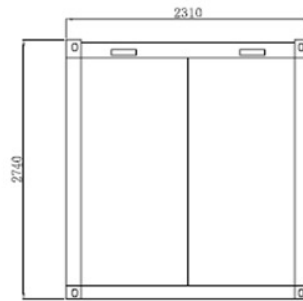
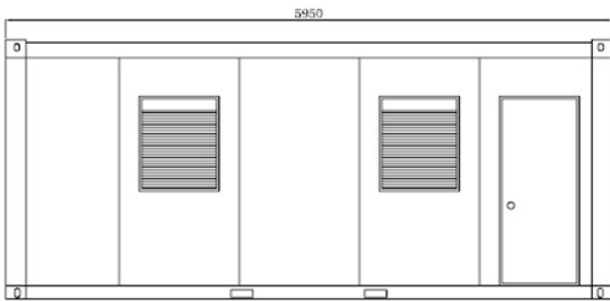

**Remark:**

1. 75mm thickness color steel sandwich wall panel , out side is color steel sheet,indoor is macromolecule decorative material .
2. Window : C-1,size:800\*1100 plastic top-hung window with window screen,the height is 1000mm from the bottom of the window to the foundation.

Door: M-1,size:800\*2000 SIP single opening door.



(1)door (4)windows

# Houses



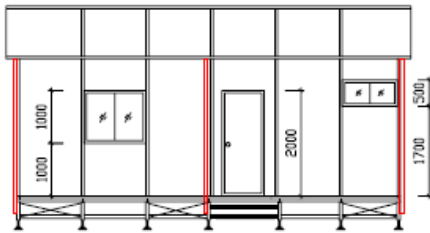

Front view

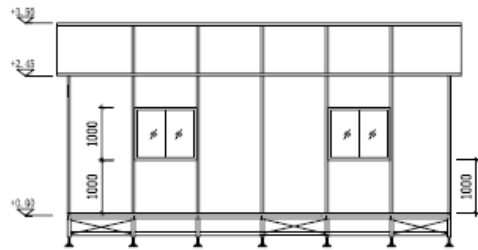

Back view

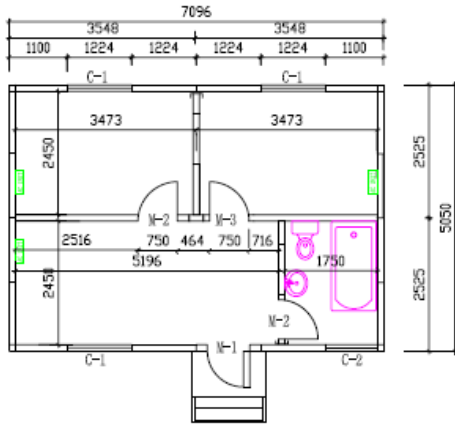

House plan

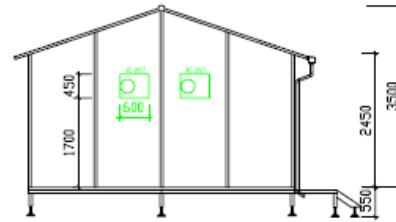

Side view

**Building area:**  
35.83 m<sup>2</sup>

MARKS	DESCRIPTION OF GOODS	AREA(SQ M)	QUANTITY (SET)	REMARKS
	PREFABRICATED HOUSE			
House part	house part	35.83		
	house building area	35.83		50mm wallpanel, 60mm roof
	celing	35.83		mineral wool board for bedroom; aluminium board for bathroom
	door		4	SIP door
	window		4	color steel sliding window
flooring system	elevated flooring steel structure	35.83	1	
	plywood	35.83	1	15mm thickness
	Pvc Vinyl Sheet , 1.5mm thickness	31.33	1	
wiring	Wiring system (including fluorecence lighting, switch off, socket, D/B box, wiring ,exhaust fan etc.)	38.53	1	
plumbing system and sanitary equipment	waterproof material with the tools	5.4	1	aluminium plate,thickness:1.5mm
	Bathroom (including the Toilet, wash basin, and all the feed-water/draining system pipes and connection parts)		1	
plumbing system and sanitary equipment	Soap Shelf Stainless Steel Mirror, Size: 0.4m*0.6m Toilet Roll Holder Stainless Steel		1	
	bathtub		1	
	Double Bar Towel Rack		1	
water collect			1	
AC support			3	
Steel Stairs			1	with antirust paint
	one set of the house			3sets of this house can fit in 40HQ

# Warehouse

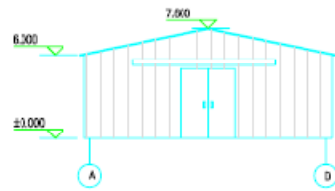
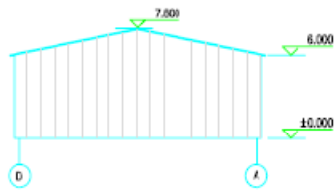
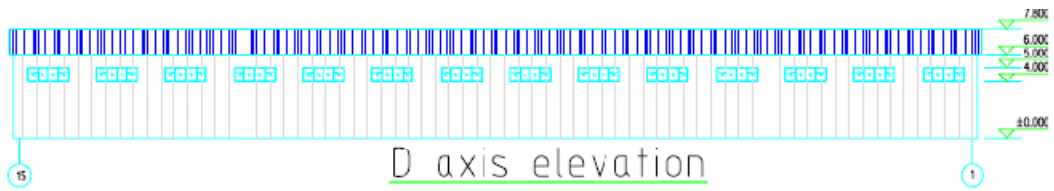
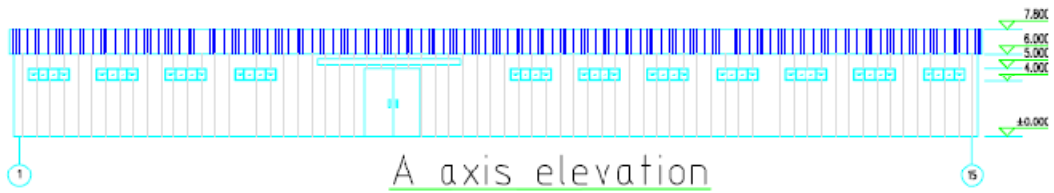

## Tools Warehouse Quotation

**House Size:** L70m\*W18m\*H6m

No.	Item	Unit	Quantity	Remark
1	outside wall	m <sup>2</sup>	1176.84	75mm color steel corrugated sandwich panel, color steel sheet 0.35mm,polystyrene 13kg/m3
2	roof board	m <sup>2</sup>	1387.03	75mm color steel corrugated sandwich panel, color steel sheet 0.35mm,polystyrene 13kg/m3
3	decorative joint fittings	m <sup>2</sup>	1260.00	color steel sheet, 0.35mm thick
4	door	pc	3.00	D-1 sliding door 4000*5000mm
5		pc	1.00	D-2 SIP door 750mm*2000mm
6	window	pc	25.00	W-1 sliding window 3000mm*1000mm
7		pc	1.00	W-2 sliding window 3000mm*1500mm
8		pc	1.00	W-3 sliding window 2500mm*1500mm
9	steel structure	kg	28,980.00	galvanized
10	chemistry anchor bolt	set	145.00	M20*260
11	common bolt	set	2,750.00	M14*35
12	high intensive bolt	set	1,390.00	M14*45
13	transport and port charge			Estimate FOUR 40HQ containers can load above goods

## Truck Warehouse Quotation

**House Size:** L70.82m\*W18.87m\*H7m

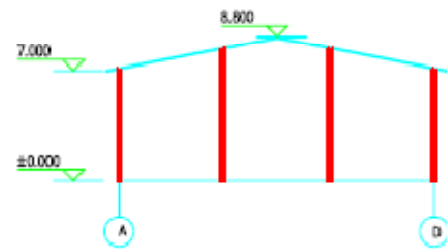
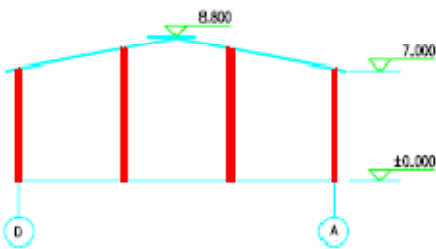
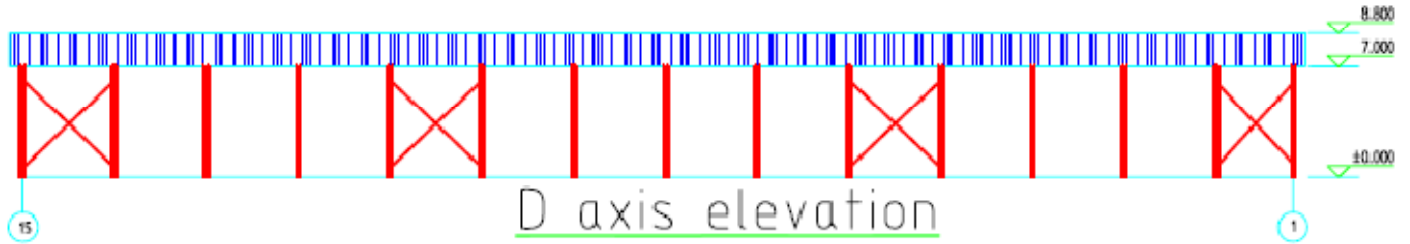
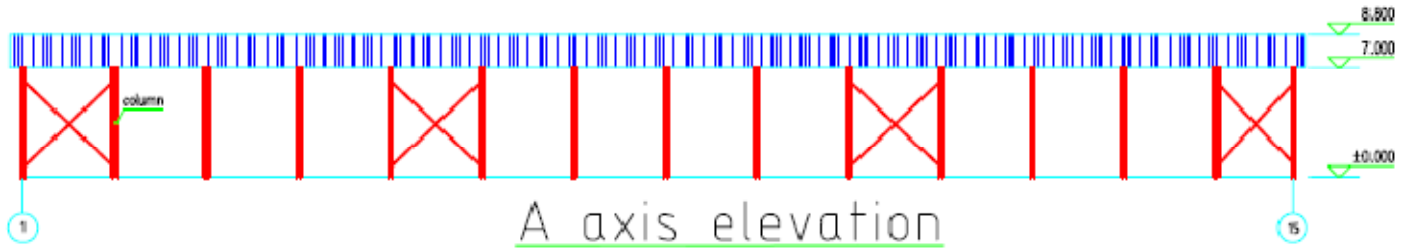

No.	Item	Unit	Quantity	Remark
1	roof board	m <sup>2</sup>	1,403.19	75mm color steel corrugated sandwich panel, color steel sheet 0.35mm, polystyrene 13kg/m <sup>3</sup>
2	decorative joint fittings	m <sup>2</sup>	1,274.76	color steel sheet, 0.35mm thick
3	steel structure	kg	29,956.86	galvanized
4	chemistry anchor bolt	set	145.00	M20*260
5	common bolt	set	2,900.00	M14*35
6	high intensive bolt	set	1,390.00	M14*45
7	transport and port charge			Estimate FIVE 40HQ containers can load above goods



**Terms:**

\*CERTIFICATE: ORIGINAL SGS CERTIFICATE THAT CONFIRMS THE RIGHT QUALITY

\*PACKING: STANDARD TRADING PACKING: -can be changed in accordance with the client, -printed on the packaging can be on the client's criteria

\*REVIEW, VERIFICATION OF GOODS ALSO DURING PACKING IN CONTAINER

\*MEASUREMENT: all can be working on the dimensions of client

**STEP UP TRADING COMPANY LTD**

China, Beijing, Chaowai Dajie No.10, Kuntai Dasha 1510, 100020 | Tel: +86 10 85656738 | [www.stepuplimited.com](http://www.stepuplimited.com) | [bjoffice@stepuplimited.com](mailto:bjoffice@stepuplimited.com)